

**Burn with Reliable,
Silent and Powerful**

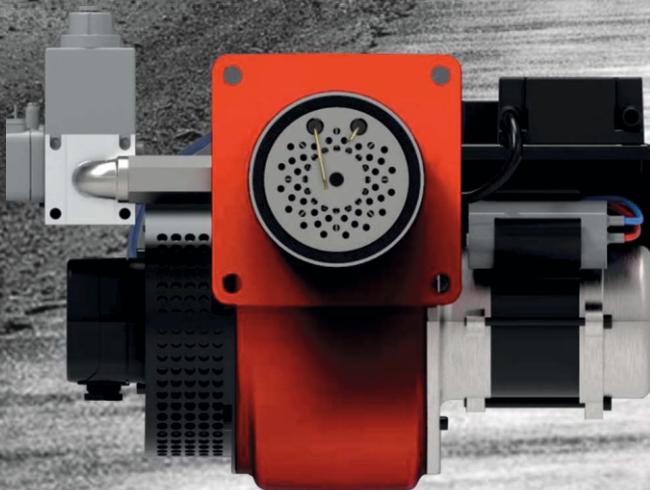

HeatGEN-Providing Heating Solution

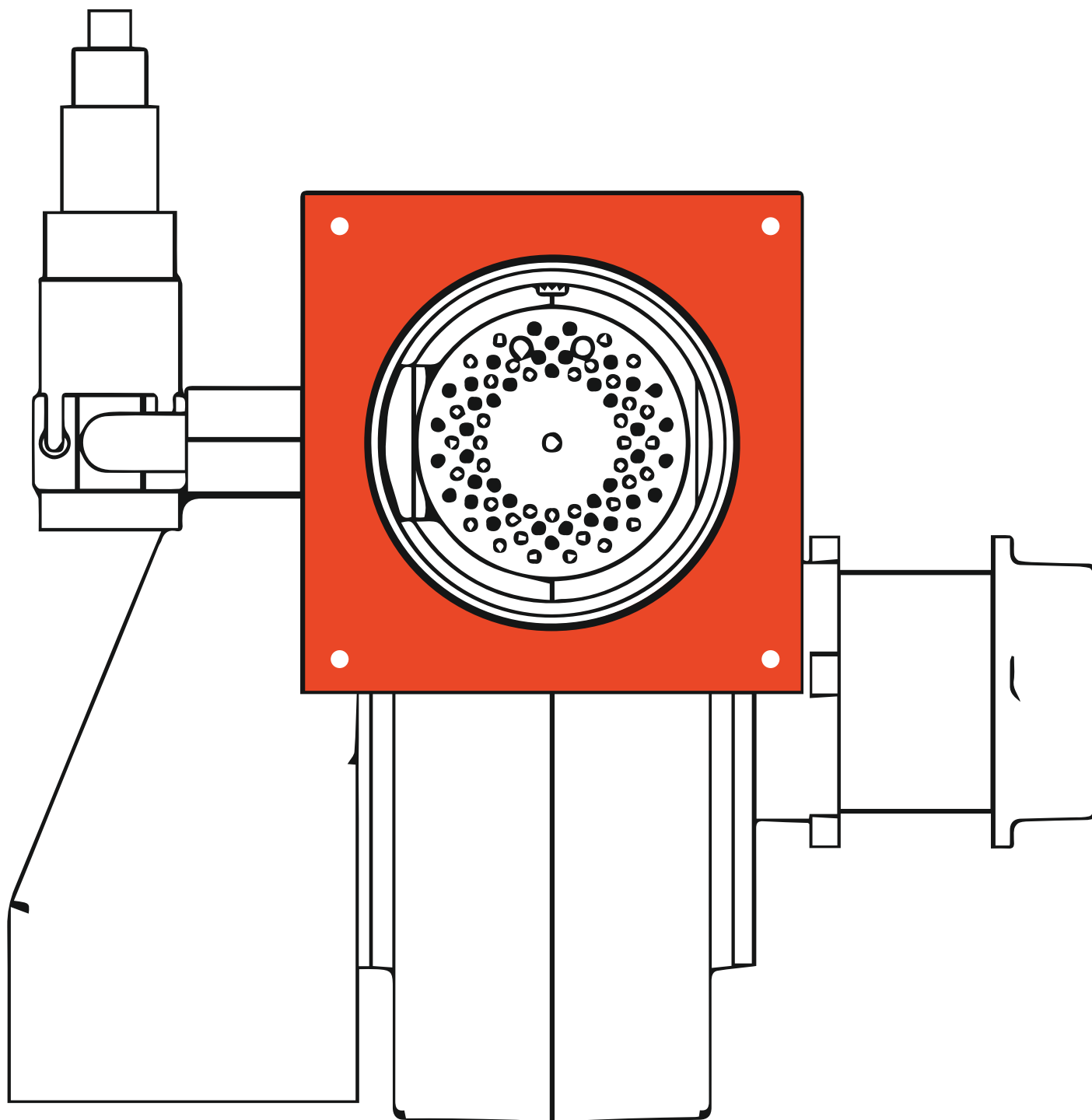



Overview



Bringing World Class Industrial Burners to Indian Industry

World-Class Industrial Burners: Advanced technology for enhanced efficiency and safety across industries.

Innovative & Reliable: Known for durability, energy efficiency, and safety, our burners lead the industry.

Our Story

Established Expertise: Trusted in the burner market with a 17-year legacy.

Global Collaborations: Partnered with industry leaders like Weishaupt and Bentone for superior combustion solutions.

Make in India Initiative: Committed to local manufacturing since 2021 with international quality standards.

Exclusive Use of Branded Parts: The only Indian company to use genuine, globally recognized spare parts.

Leadership in Innovation: At the forefront of burner manufacturing in India, supported by expertly trained technicians.

Commencing the Optimal Solution



Product Portfolio



The combustion and heating needs of different enterprises are varied. At HeatGEN, we specialize in the supply and service of compact Burners and their authentic spare parts. Check out our range of dependable, durable, and efficient Industrial Burners below:

HeatGEN Gas Burner 33-1250 Kw

Achieving the Pinnacle of Precision With a focus on precision & efficiency, HeatGEN has incorporated a specially produced turbulence system to ensure impeccable combustion for both LPG (liquefied petroleum gas) and natural gas. This Model is available in Single-stage, Two-stage, and Modulated configurations.

Key Highlights

- We provide the option of Dungs Multiblock/ Solenoid Valve for additional safety
- Dungs Make Pressure Switch
- Siemens Make Controller
- User-friendly Control System with rigid Aluminum Body
- Danfoss make Transformer
- Specially designed Diffuser Assembly and SS Blast Tube for better combustion
- Siemens Servo Motor
- Our Own developed blower motor
- Combustion with free maintenance
- Convenient spare parts availability
- At your doorstep services
- Annual Maintenance contract (AMC)

Why choose us



Global Standards, Local Value

HeatGEN sets itself apart as the only manufacturer in India offering products on par with international brands, providing exceptional quality at competitive prices.

Cutting-Edge Combustion Technology

High fuel efficiency, low emissions, and quiet operation, designed to global standards.

Enhanced Environmental Sustainability

Optimal air-to-gas ratios reduce emissions and prevent unburnt gases, lowering air pollution.

Space-Saving and Lightweight Design

Strong, ultra-thin aluminum makes our burners compact and lightweight, enhancing space efficiency.

Tailored Combustion Excellence

Decades of expertise enable customized, optimized burner solutions tailored to precise client needs.

Zero Maintenance Burners

Our 'Fit It, Forget It' burners require virtually no maintenance, ensuring cost savings.

Immediate Access to Spare Parts

Ready inventory of genuine spares ensures continuous operation with no downtime.

Rapid Response Support

Contact HeatGEN Technical Services, our specialized support division, for prompt assistance with installation, maintenance, and training

Towards this end, we have established a separate unit named HeatGEN Technical Services. This firm focuses exclusively on Installation, Commissioning, and Maintenance activities as well as providing Technical Training to client staff.



Vision

Our Vision is to manufacture Industrial Gas Burners up to 5,000 Kw under the 'Made in India' initiative and achieve the successful installation of 1,200 units by 2025, supported by a robust, worldwide dealership network.



Mission

We, HeatGEN, are manufacturers of industrial gas burners, providing services for supply, installation, and commissioning. It comprises supplementary equipment and after-sales support to ensure customer satisfaction.

We have 17 years of experience in world class combustion technology. Implementing rigorous quality control procedures, establishing in-house R&D testing facilities, fostering innovation for ongoing product development, and guaranteeing products of exceptional quality and value for money and instilling a sense of pride in ownership among customers worldwide.

HeatGEN's Gas Burner technology product is customized to meet the specific requirements of the various industries like Automobile Industry, Food Industry, Pharmaceutical Industry, Chemical Process Industry, Steel Industry, Glass Industry, Dairy Plant Textile Industry, Agriculture, Refrigeration, wood industry, etc.



Core Values



Quality

We are committed to making world class Industrial Burners that excel in every aspect of their operation.



Integrity

We inspire trust in all areas of our business through transparency in thought & action.



Innovation

We are driven by the idea of constantly developing new and improved products.



Customer Focus

We put our customers and their needs at the center of our business.



Safety

The safety of our employees, customers, and business partners is paramount to us.



Reliability

We ensure all our products perform consistently well during their entire lifespan.



Sustainability

Our Products, Processes, and Practices are aligned so as to minimize their ecological impact.

Single Stage

HG 100-150

33 - 150 Kw

Long service life and problem-free operation in dusty and dirty environments with its helix and Aluminium rigid body construction.



Capacity Table

Model	Capacity						Voltage	Gas Line Size	Pressure range mbar	Weight
	Gas m3/hr		Kcal/hr		Kw					
	Min	Max	Min	Max	Min	Max				
HG 100	1	4	28380	86000	33	100	220	½"	20-300	12kg
HG 150	3	6	43000	129000	50	150	220	½"	20-300	13kg

Dimension

Model	Dim.A	Dim.B	Dim.C	Dim.D	Dim.E	Dim.F	Dim. G	O.D.	Pipe Thread
HG 100	462.8	213.3	155	178.4	394.6	292.8	181.5	100	1/2" BSP
HG 150	462.8	213.3	155	178.4	394.6	292.8	181.5	110	1/2" BSP

Combustion Dims in mm

Head	d1	d2	d3	d4	d5	l1
HG 100	100	M8	170	120	104	152
HG 150	110	M8	170	120	114	152



Graph

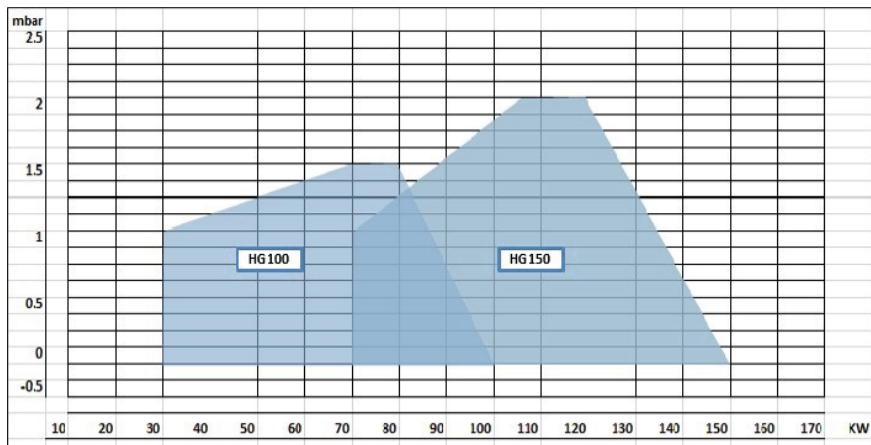

The values to be determined at the curves, show approximate combusted amount of fuel in the combustion chamber according to burner types and depending on the combustion chamber pressure in normal working conditions. The combustible amount of fuel for burner is determined by actual measurements at the current facility according to combustion chamber forms & flue types of boilers & heat exchangers.

Burner Dimension

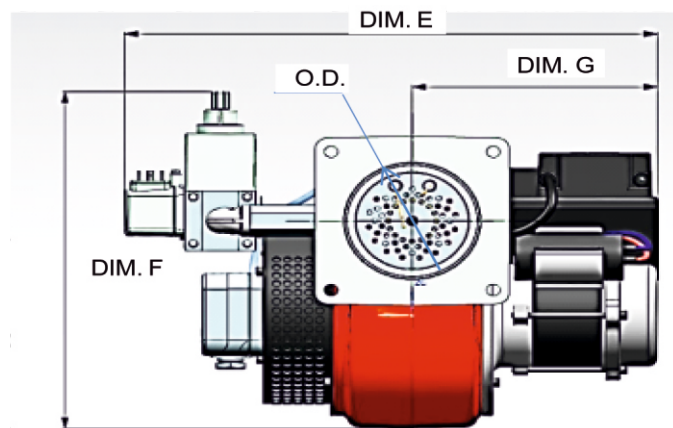
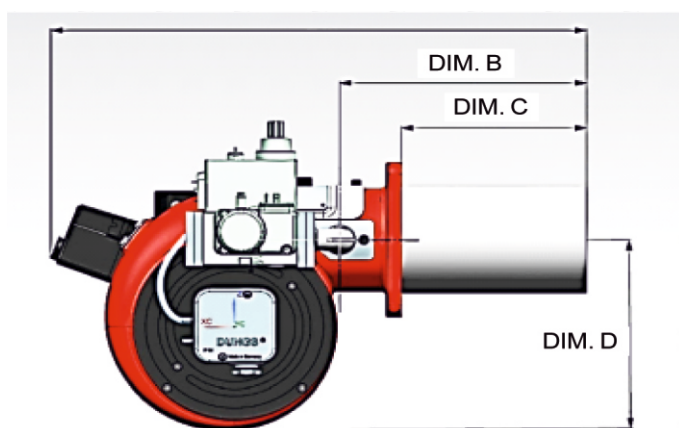

Refractory and drilling dimensions

Refractory Flange gasket

The gap between combustion head and refractory must be filled with resilient, non-combustible insulating material. Do not make solid.

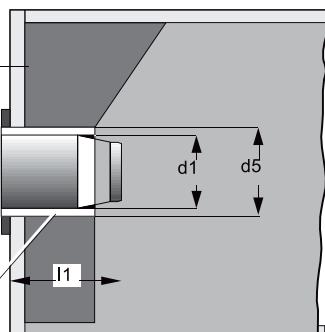

Drilling dimensions on heat exchanger

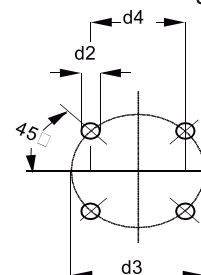

Single Stage

HG 250-350

80-350 Kw

Effective combustion at minimum & maximum capacities with sensitive valve system.

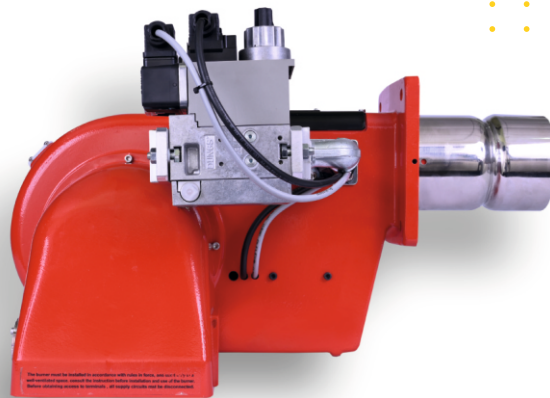

Capacity Table

Model	Capacity						Voltage	Gas Line Size	Pressure range mbar	Weight
	Gas in KG		Kcal/hr		Kw					
	Min	Max	Min	Max	Min	Max				
HG 250	6.5	20	68800	215000	80	250	220V	¾'	20-300	22kg
HG 350	8.5	28	94600	301000	110	350	220V	¾'	20-300	23kg

Dimension

Model	Dim.A	Dim.B	Dim.C	Dim.D	Dim.E	Dim.F	Dim. G	O.D.	Pipe Thread
HG 250	615.3	373.5	163	221.4	455.3	360.2	197	117	3/4" BSP
HG 350	638.3	396.5	160	221.4	455.3	360.2	197	122	3/4" BSP

Combustion Dims in mm

Head	d1	d2	d3	d4	d5	l1
HG 250	117	M10	203	144	120	164
HG 350	122	M10	203	144	125	183

HG 250-350



Graph

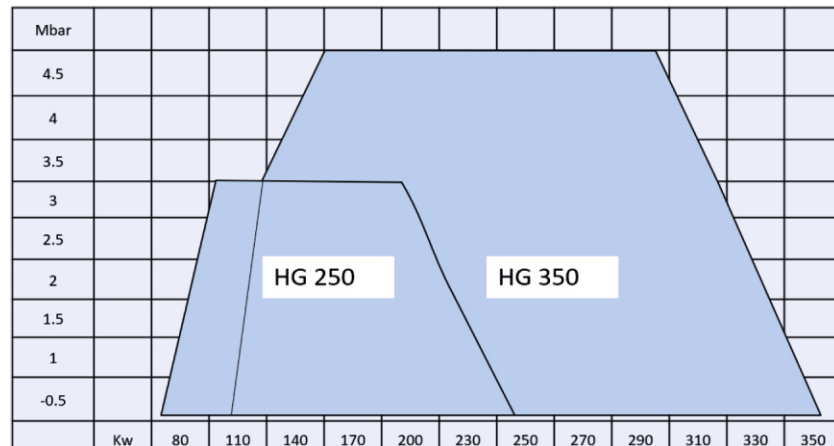

The values to be determined at the curves, show approximate combusted amount of fuel in the combustion chamber according to burner types and depending on the combustion chamber pressure in normal working conditions. The combustible amount of fuel for burner is determined by actual measurements at the current facility according to combustion chamber forms & flue types of boilers & heat exchangers.

Burner Dimension

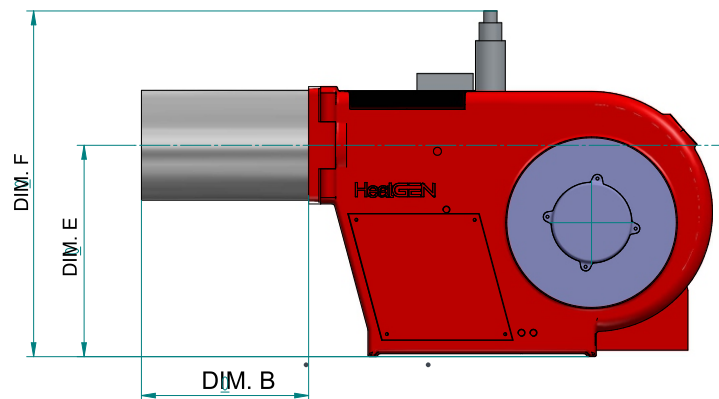
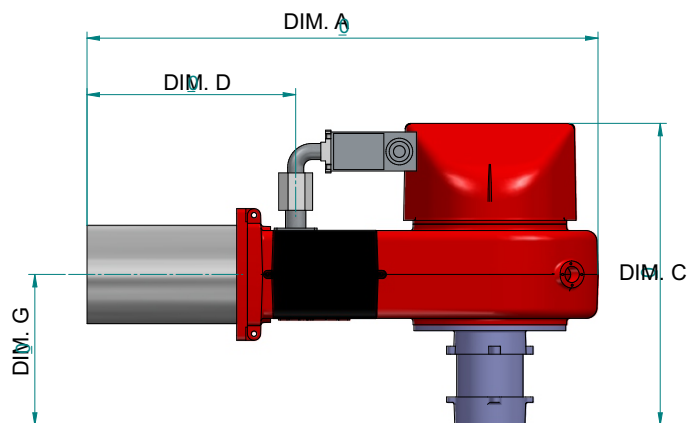

Refractory and drilling dimensions

Refractory Flange gasket

The gap between combustion head and refractory must be filled with resilient, non-combustible insulating material. Do not make solid.

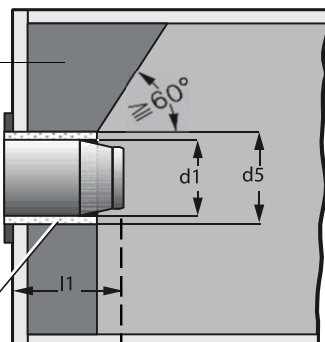

Drilling dimensions on heat exchanger

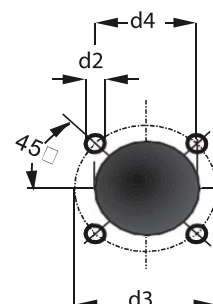

Premium Industrial Burners with the Right Blend of 'Price' and Performance'



The Siemens combustion control unit ensures high efficiency and low NOx emissions, specifically designed for optimal performance.



Opting for a premium servomotor ensures the attainment of an ideal air-fuel mixture, promoting highly efficient combustion.



The Dungs Gas Multiblock serves as a safety and control device for gas-fired appliances. It ensures proper gas flow, ignition, and flame monitoring.



Even under challenging conditions, the specially designed gas-air mixture path construction ensures consistently high combustion efficiency.

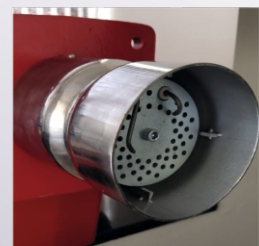

The installation process is simple and practical, allowing for easy servicing and maintenance interventions.



Two Stage

HG 250-2/350-2

83-350 Kw

Combustion head with adjustment at high performance and elevated flame stability equipped with inox steelblast tube and S-O-A diffuser assembly.

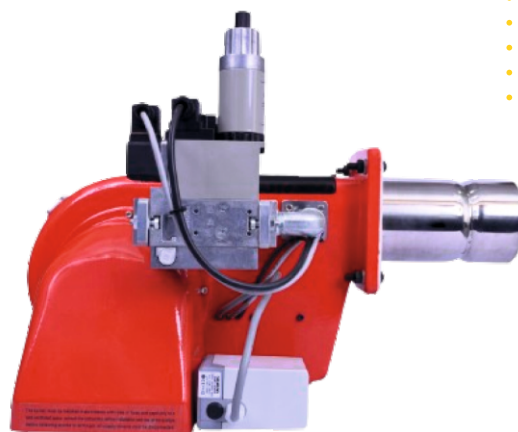

Capacity Table

Model	Capacity						Voltage	Gas Line Size	Pressure range mbar	Weight
	Gas in KG		Kcal/hr		Kw					
	Min	Max	Min	Max	Min	Max				
HG 250-2	6.5	20	68800	215000	80	250	220V	¾"	20-300	22kg
HG 350-2	8.8	28	94600	301000	110	350	220V	¾"	20-300	23kg

Dimension

Model	Dim.A	Dim.B	Dim.C	Dim.D	Dim.E	Dim.F	Dim. G	O.D.	Pipe Thread
HG 250-2	615.3	373.5	163	221.4	455.3	360.2	197	117	3/4" BSP
HG 350-2	638.3	396.5	186	221.4	455.3	360.2	197	122	3/4" BSP

Combustion Dims in mm

Head	d1	d2	d3	d4	d5	l1
HG 250	117	M10	203	144	120	164
HG 350	122	M10	203	144	125	183

HG 250-2/350-2



Graph



The values to be determined at the curves, show approximate combusted amount of fuel in the combustion chamber according to burner types and depending on the combustion chamber pressure in normal working conditions. The combustible amount of fuel for burner is determined by actual measurements at the current facility according to combustion chamber forms & flue types of boilers & heat exchangers.

Burner Dimension

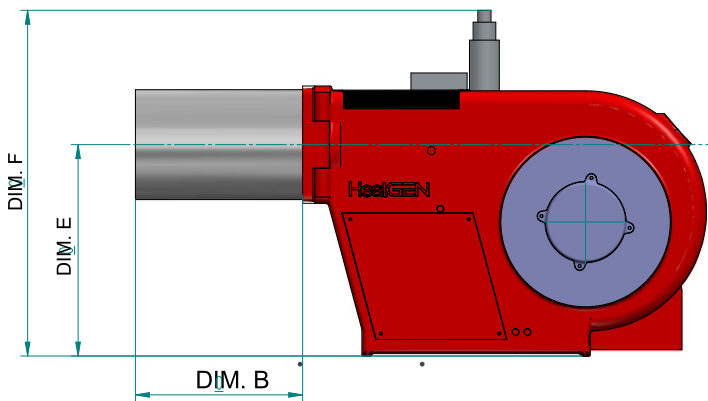
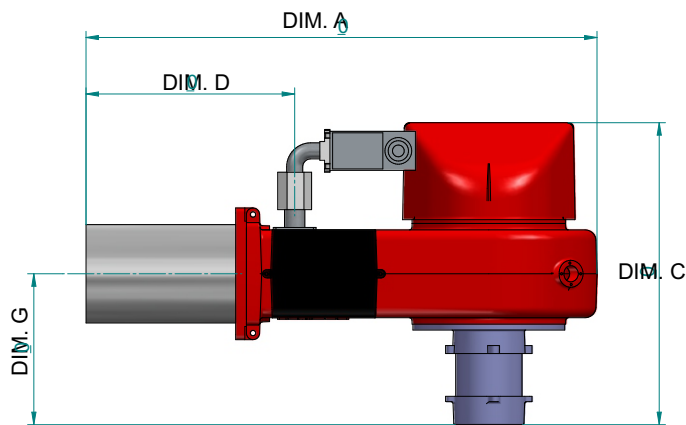

Refractory and drilling dimensions

Refractory Flange gasket

The gap between combustion head and refractory must be filled with resilient, non-combustible insulating material. Do not make solid.

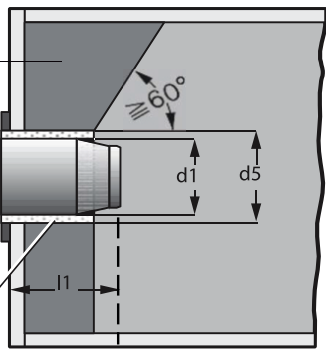

Drilling dimensions on heat exchanger

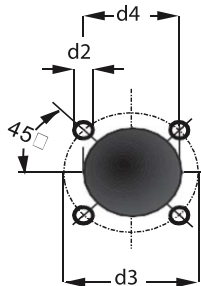

Two Stage

HG 550-2 / 750-2

160-750 Kw

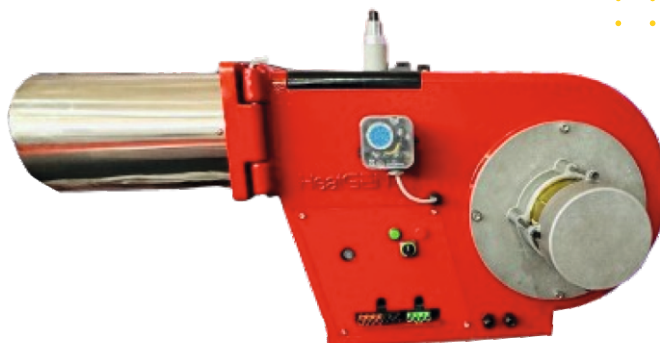

Servomotor for air shutter and for the consent of the 2nd stage gas valve.

Capacity Table

Model	Capacity						Voltage	Gas Line Size	Pressure range mbar	Weight
	Gas in KG		Kcal/hr		Kw					
	Min	Max	Min	Max	Min	Max				
HG 550-2	12	42	137600	473000	160	550	220 V	1"	50-300	50kg
HG 750-2	14	57	159100	645000	185	750	220 V	1 ½"	50-300	52kg

Dimension

Model	Dim.A	Dim.B	Dim.C	Dim.D	Dim.E	Dim.F	Dim. G	Dim.H	Dim.I	Pipe Thread
HG 550-2	282	552	343	158	280	676	354	444	579	1"
HG 750-2	282	552	343	158	280	676	354	444	579	1.5"

Combustion Dims in mm

Head	d1	d2	d3	d4	d5	l1
HG 550-2	184	M14	220	150	164	280
HG 750-2	184	M14	220	150	190	280



Graph

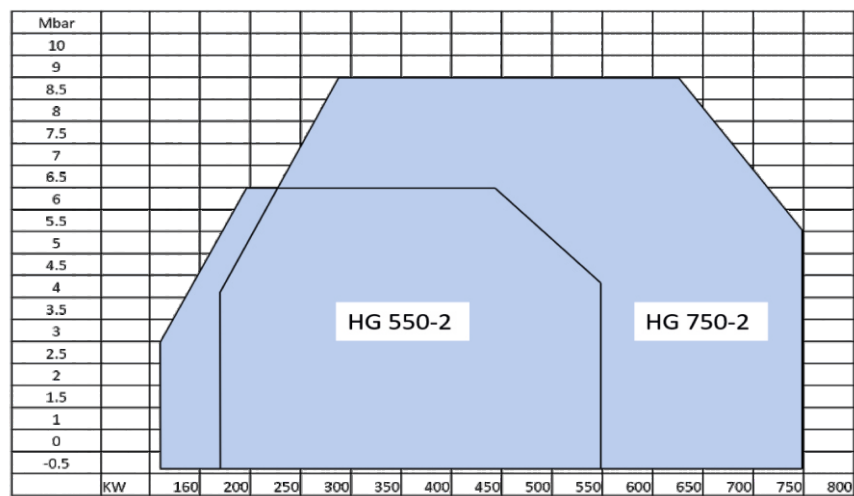

The values to be determined at the curves, show approximate combusted amount of fuel in the combustion chamber according to burner types and depending on the combustion chamber pressure in normal working conditions. The combustible amount of fuel for burner is determined by actual measurements at the current facility according to combustion chamber forms & flue types of boilers & heat exchangers.

Burner Dimension

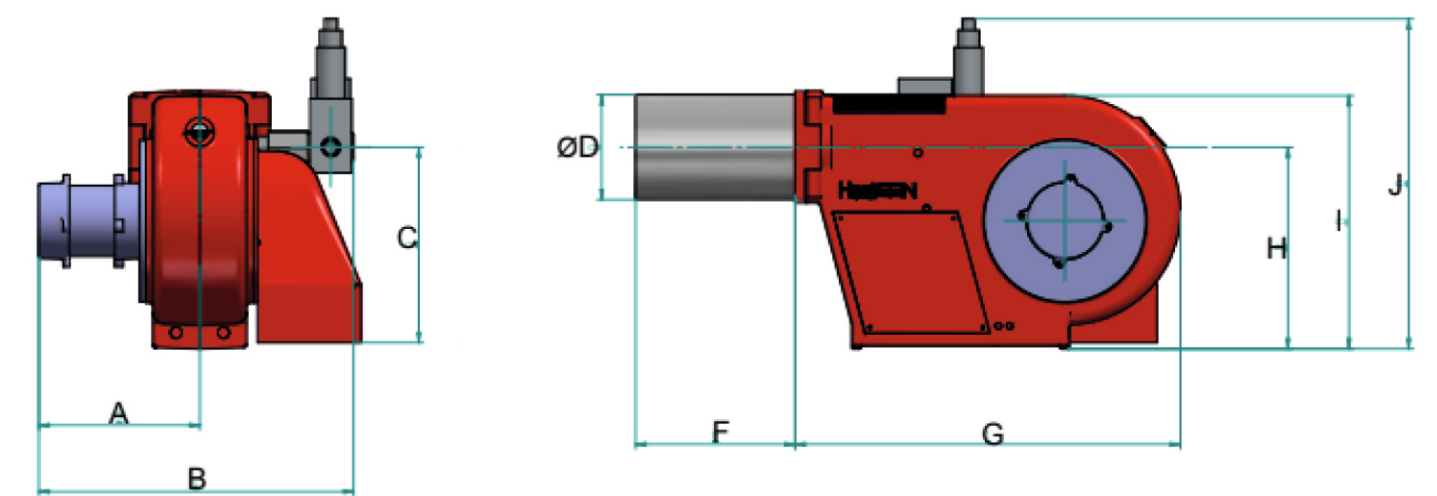

Refractory and drilling dimensions

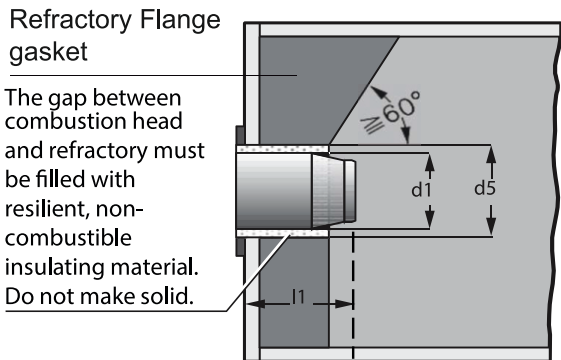

Drilling dimensions on heat exchanger

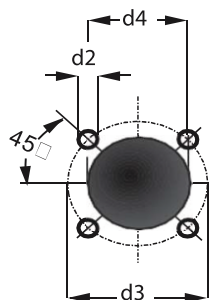

Two Stage

HG 1250-2

290-1250 Kw



Enclosed Control Panel- Protects
from Dust. Hazardous free.

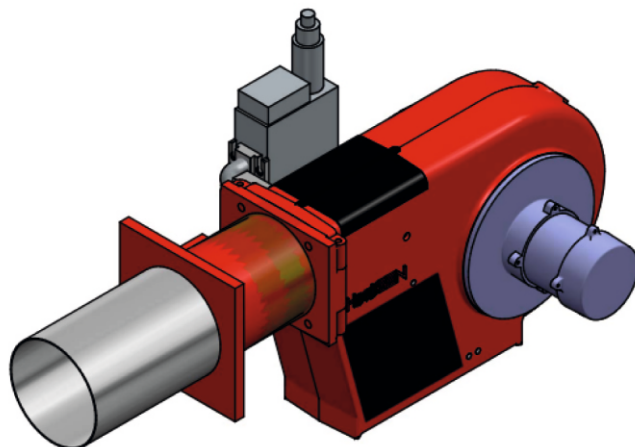

Capacity Table

Model	Capacity						Voltage	Gas Line Size	Pressure range mbar	Weight
	Gas Nm3/hr		Kcal/hr		Kw					
	Min	Max	Min	Max	Min	Max				
HG 1250-2	22	94	249400	1075000	290	1250	220 V	1”	50-300	58Kg

Dimension

Model	Dim.A	Dim.B	Dim.C	Dim.D	Dim.E	Dim.F	Dim. G	Dim.H	Dim.I	Dim.J	Pipe Thread
HG 1250-2	282	552	343	194	280	500	680	354	444	629	1.5"

Combustion Dims in mm

Head	d1	d2	d3	d4	d5	l1
HG 1250-2	194	M14	220	200	200	280

HG 1250 -2



Graph

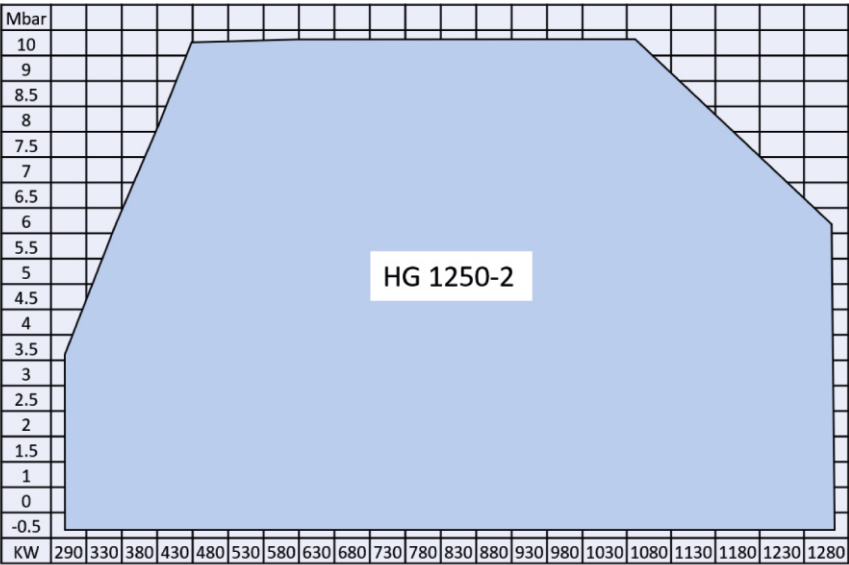

The values to be determined at the curves, show approximate combusted amount of fuel in the combustion chamber according to burner types and depending on the combustion chamber pressure in normal working conditions. The combustible amount of fuel for burner is determined by actual measurements at the current facility according to combustion chamber forms & flue types of boilers & heat exchangers.

Burner Dimension

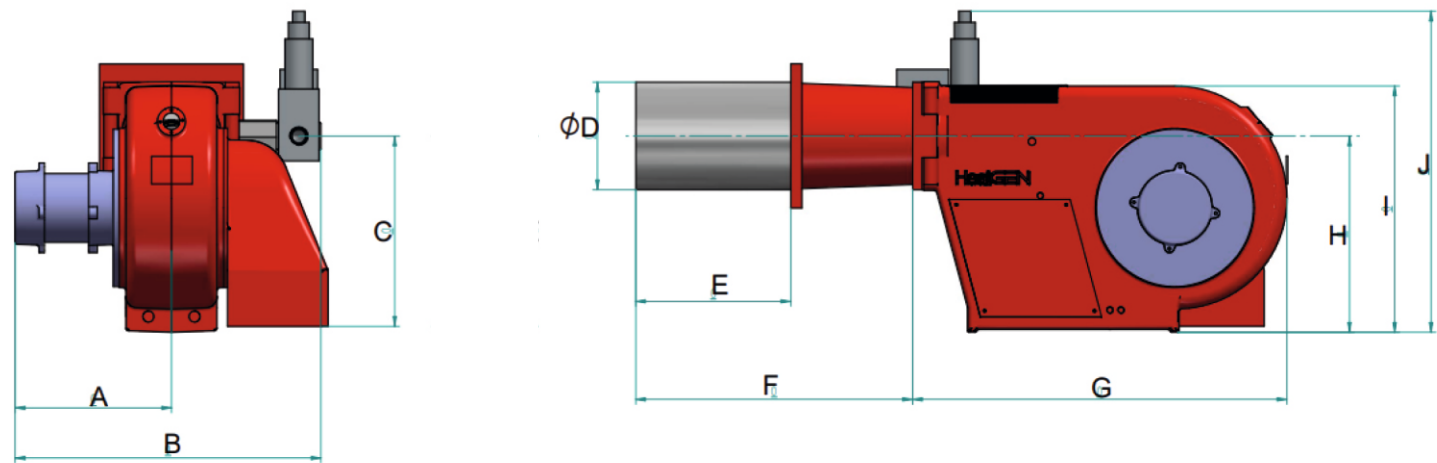

Refractory and drilling dimensions

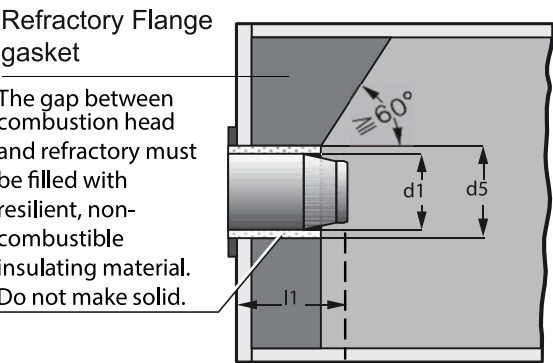

Drilling dimensions on heat exchanger

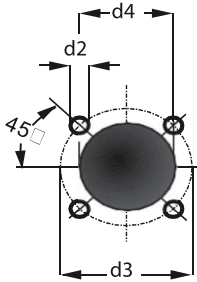



Modulating Gas Burner

Our HeatGEN Gas Burners are meticulously crafted in single-stage, two-stage, and modulated variations, featuring an innovative turbulence system designed to optimize combustion for both natural gas and LPG propane. Renowned for their exceptional efficiency and cost-effectiveness, these burners are finely attuned to gas and air pressure fluctuations, as well as voltage changes.

Should there be any deviation from the specified pressure or voltage parameters, our advanced safety mechanisms swiftly activate, ensuring maximum protection. We exclusively incorporate internationally recognized, top-tier components in our burners, with all imported elements meeting stringent A-class standards and holding prestigious TSE and CE certifications. For local production, we adhere to the same exacting standards, utilizing certified components to maintain unparalleled quality and reliability

Reliable operation with sliding-two-stage or modulating operation, depending on version and method of capacity regulation.

Sliding-two-stage or modulating operation.

- **Stepping motors adjust the capacity between partial load and full load depending on the heat demand.**
- **There is a gradual change between both load points. There are no sudden, large changes in fuel throughput.**
- **Servo motor for Gas/ more accuracy w.r.t. Air- Gas ratio adjustment.**
- **Tripping Chances is very – very less.**
- **Percentage wise Modulate Flame as per load /requirement.**

Modulating Gas Burner

80-1250 Kw

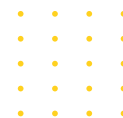

Modulated burners coming with full efficient combustion is by installing the well-designed Dungs gas armature along with the latest technology for the sequence control functions with safe and reliable combustion.



Capacity Table

Model	Capacity						Voltage	Gas Line Size	Pressure range mbar	Weight
	Gas m3/hr		Kcal/hr		Kw					
	Min	Max	Min	Max	Min	Max				
HG 250-M	6.5	20	68800	215000	80	250	220V	3/4"	20-50	26kg
HG 350-M	6.8	28	94600	301000	110	350	220V	3/4"	20-300	27kg
HG 550-M	12	42	137600	473000	160	550	220V	1"	50-300	54kg
HG 750-M	14	57	159100	645000	185	750	220V	1 ½"	50-300	56kg
HG 1250-M	22	94	249400	1075000	290	1250	220V	1 ½"	100-300	64kg

HG 250 M / 350 M

Graph

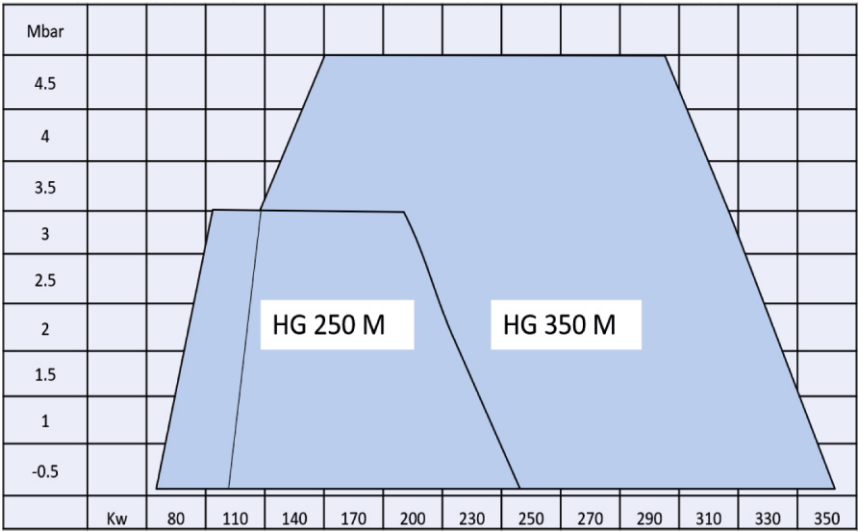

The values to be determined at the curves, show approximate combusted amount of fuel in the combustion chamber according to burner types and depending on the combustion chamber pressure in normal working conditions. The combustible amount of fuel for burner is determined by actual measurements at the current facility according to combustion chamber forms & flue types of boilers & heat exchangers.

HG 550 M / 750 M /1250 M

Graph

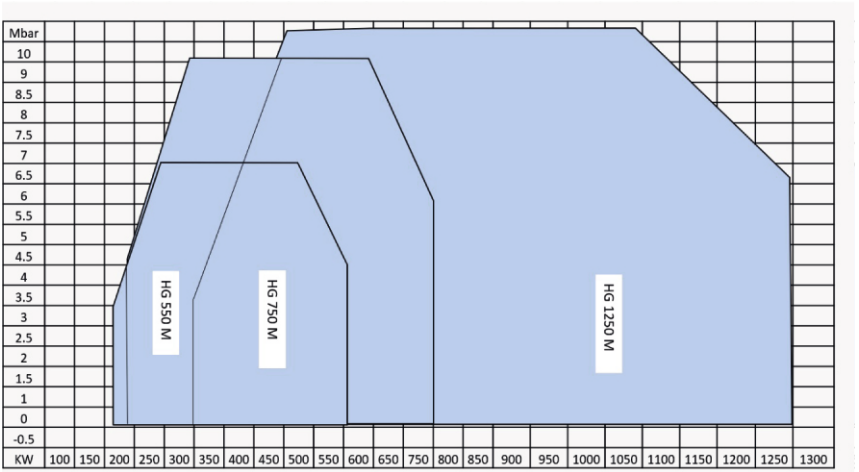

The values to be determined at the curves, show approximate combusted amount of fuel in the combustion chamber according to burner types and depending on the combustion chamber pressure in normal working conditions. The combustible amount of fuel for burner is determined by actual measurements at the current facility according to combustion chamber forms & flue types of boilers & heat exchangers.

Weishaupt Gas-Oil-Dual fuel Burners



We have an additional parent company known as HeatGEN Engineering Systems, which specializes in importing Weishaupt burners.

W-series Weishaupt

All W - Series Weishaupt Gas Burner use the latest microprocessor technology for the control and monitoring of all the burnerfunctions

GAS	WG5-WG40	12.5kW-550kW
OIL	WL5-WL40	16.5kW-570kW
DUELFUEL	WGL 30-WGL40	70kW-550kW



WK-Series Weishaupt

WK-series burners are Weishaupt's most powerful burners. Rated up to 109,000 MBTU/h they have been designed primarily for heavyduty industrial applications. They are are availableas gas, oil or dual-fuelburners..

GAS	WKG40-WKG80	300 kW-22000kW
OIL	WKL & WKMS40/80	300 kW-22000kW
DUELFUEL	WKGL & WKGMS40/80	300 kW-22000 kW



Industrial Weishaupt Monarch

Weishaupt industrial gas burners, sizes 30 to 70, has been especid designed for industrial capacity ranges The monoblock burners a noteworthy for their large capacity andoperationalranges

GAS	SIZE1-11	60 kW-4750kW
OIL	SIZE1-11	70 kW-5240kW
DUELFUEL	SIZE1-11	60 kW-4750kW
HEAVYOIL	SIZE30-70	475 kW-8750kW



WM-Series Weishaupt

Weishaupt WM Series gas burners are equipped as standard \ electronic compound regulation and digital combustion managment. Modern combustion technologies demand a precise, continually reproducible dosingoffuel andcombustion air.

GAS	WMG10-WMG50	55 kW-11000 kW
OIL	WML10-WML50	75 kW-11000kW
DUELFUEL	WMGL10-WMGL50	65 kW-11000kW
HEAVYOIL	WMS10-WMS30	100kW-5600kW



Spare Parts

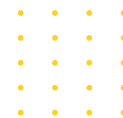

Servomotor



Multibloc



Suntec Oil Pumps



Displayunit



Blowermotor



Nozzle



Fan Wheel

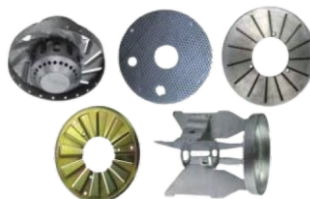

Blasttube & Diffuser



Electrodes



Solenoidvalves



Ignition Transformer



Combustionmanager/
Sequencecontroller



Flame Sensors



Dungs Gas & Air
Pressure Switch



Pressure Regulators

Our Customers

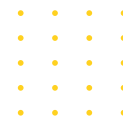

Customer Service: We're on hand to help immediately with maintenance and advice.



A separate unit of the firm named HeatGEN Technical Services has been formulated recently to become a powerful arm to provide practical Support as well as Solutions for Installation, Commissioning and Maintenance activities as well as customer training needs. The installation is carried out as per the high standards set by our principals and the documentation takes care of existing operating conditions in India in addition to that laid down by our principals.

Internationally trained technical staff undertakes and ensures effective functioning and performance monitoring of burner and heating equipment on a regular basis by adopting a proactive approach. The Annual Maintenance Contracts have been found to be very useful by the customers.

HeatGEN Technical Services also provides the training for burner operation to customers on site.



Annual Maintenance Contracts



Provide Practical Support



Burner Sequential Controller Test Kit



Specially Designed Combustion head



Fule Gas analyzer



Simulator for operation of microprocessor based combustion manager

Appreciation Letters of our valuable customers



SHARP THERMAL ENGINEERS PVT. LTD.,

GAT NO. 68, PLOT NO. 10, TALAWADE, PUNE- 412 114

* MO: 9822041373 / 9881712015.

Email: sharptherm@gmail.com + web: www.sharpthermal.net

Ref. No. : STE: 07: HPL: 23:24

21 August 2023

SUBJECT: Letter of Appreciation

Dear HeatGEN Combustion Pvt Ltd,

We are writing to express our heartfelt appreciation for the outstanding HeatGEN Gas Burner that your team has produced and supplied to our OVENS, PAN INDIA. The dedication, innovation, and high quality that have gone into its creation are truly commendable.

Make :- HeatGEN Gas Burner (Make IN India)

Capacity of Burner – 250Kw-20 NOS.
Type ON/OFF
Controller-LME11

The attention to detail and the relentless pursuit of perfection have resulted in a product that not only meets but exceeds expectations. Your efforts have undoubtedly showcased the potential of Indian manufacturing and have garnered admiration from all corners.

Overall, burner performance is phenomenal. We would like to thank and appreciate the technical competence, professional execution capabilities and timely site services of M/S HeatGEN team.

Warm regards,

Yours faithfully,
For SHARP THERMAL ENGINEERS PVT. LTD.

MANOJ A. KUMAR
[DIRECTOR]
9822041373

MULTI SALES CORPORATION

Corporate Office : 51, Shivaji Housing Society, 12th Lane Rajarampuri, Kolhapur 416008

Tel : 9423042574, 8329543753 E-mail : multi_sales@rediffmail.com

Sales Office / Godown: C-3/19, Five Star MIDC Kagal- Hatkangale, Kolhapur 416236

Tel : 9422074235, 9156764135 GST No : 27AAYPJ6114E1ZJ

To,

HeatGEN Combustion Pvt. Ltd

We are using below HeatGEN Industrial Gas Burners:

1. HG 150 single stage with Dungs Solenoid Valve
2. HG 250 Single stage with Dungs Multiblock

and they are working efficiently. The burners are operating on Natural Gas.

We are happy with their service and product. We recommend HeatGEN Gas Burners for heating applications, sand dryers, powder coating applications and many more.

Once again, thank you for your hard work, dedication, and positive impact. It is a pleasure to have you as a part of organization and I look forward to witnessing your ongoing success.

With Best Regards

Multi Sales Corporation



YES SAND LLP

A-68, M.I.D.C., Chindholi, KONDHI,
North Solapur, SOLAPUR - 413 255.
Mob. : 8605681888
E-mail : yessand2021@gmail.com,
sksapre3@gmail.com

Appreciation Letter

Dear HeatGEN Team,

On behalf of YES Sand LLP, the product itself has exceeded our expectations in terms of quality, functionality, and design. Its performance has made a significant positive impact on our operations, and it is a testament to your commitment to excellence.

Specially we feel proud for using Make in INDIA Burner.

We satisfied by using below burners:

HG 150 with Dungs Solenoid Valve- 2 Qty

In a market where outstanding service is a rarity, your company stands out as a shining example of how businesses should operate. It is clear that your team's dedication to delivering not only a superior product but also an exceptional overall experience sets you apart.

We look forward for continuous supply and service. Once again, thank you for the remarkable product and service that you have provided.

Yours Truly,

Name: Vaibhav Budhner



JAY GANESH ECOTECH SYSTEM

Work & Office : J-13/11, Addl. MIDC, Near Spicer India Ltd. Satara - 415004.
Website : jayganeshecotech.com E-mail : jayganesh1917@gmail.com
Cell No : +91 9373054941 / +91 9922277921

To whom it may concern

I am writing this letter to express my sincere appreciation to M/s HeatGEN for their own manufactured (Make in India) HeatGEN Industrial Gas Burner. I wanted to take a moment to acknowledge your outstanding dedication and hard work.

We are using below Model

1. HG 100 (Bramha Solenoid Valve)- 10 Nos

2. HG 250 (Dungs Solenoid Valve)- 1 No

I want to personally thank you for your contributions and let you know that your efforts do not go unrecognized. Your dedication reflects the values and goals and I am confident that your continued involvement will lead to even greater achievements in the future.

Best Regards,







Adinath Gore (Sales Director)

Adinath Gore brings to the table over 20 years' experience in the Industrial Burners domain. After completing his post-graduation in commerce, he worked as Team Manager at Rajni International.

Entrusted with handling Nagpur, Pune, & Mumbai regions, he skillfully looked after the company's finances. Gaining valuable industry insights & excellent techno-commercial skills during his career, he decided to embark on an entrepreneurial journey along with Shashikant Nalkar.

A passionate businessperson at heart, Adinath's work has found due appreciation in industry circles; he has been honoured with the **Marathwada Udyojak Award**.



Shashikant Nalkar (Technical Director)

An electrical engineer by qualification, Shashikant is the technical brain at HeatGEN. His prolific experience of 20+ years in the Boiler-Burner industry is the driving force behind the innovations taking place at the company.

Shashikant has successfully completed Weishaupt Burner Training in Germany (twice) and is honored with the **Boiler 1st Class Engineer and Boiler Proficiency Engineer Awards**.



Certificates



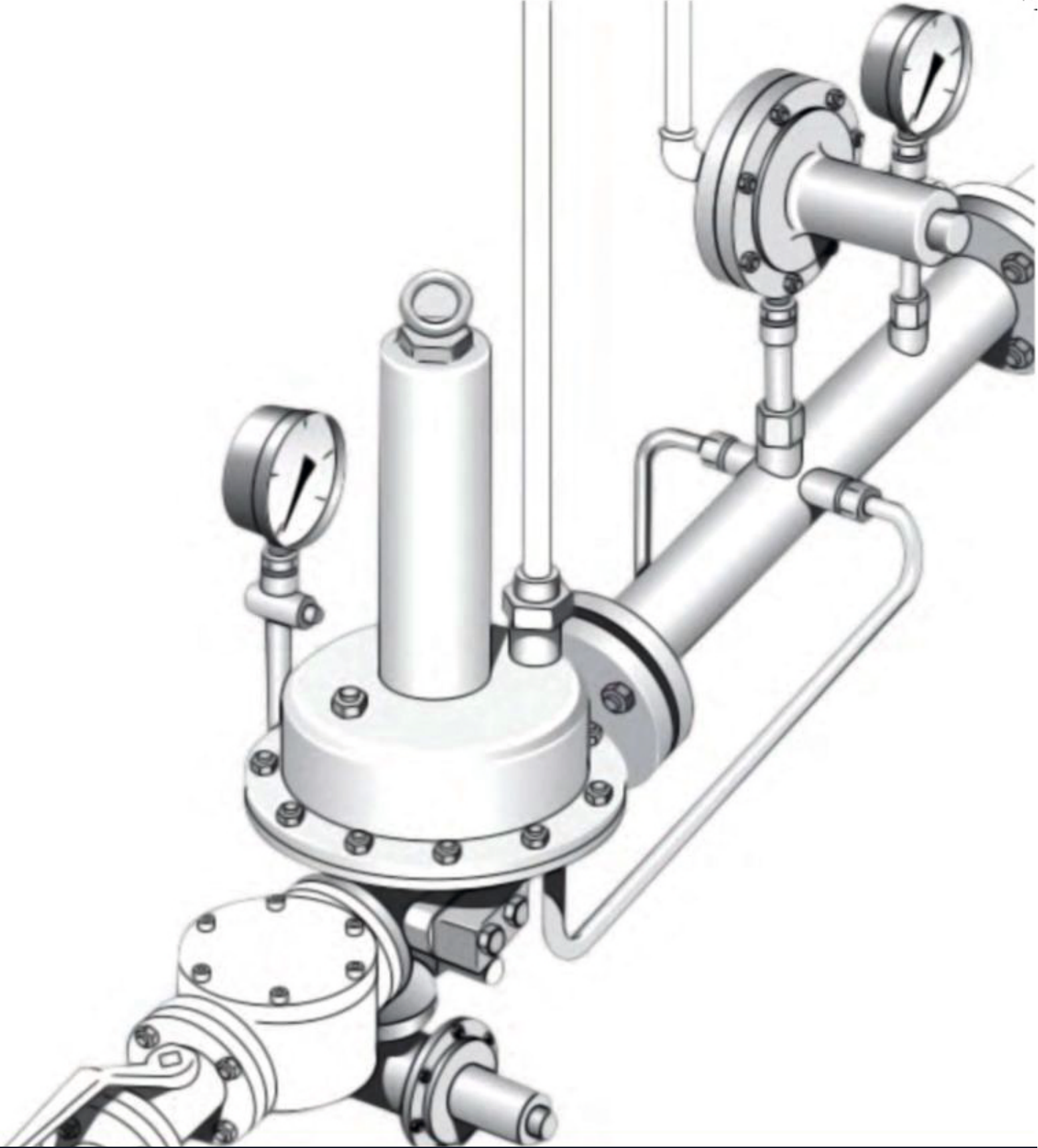

HeatGEN Engineering Systems
HeatGEN Combustions Pvt. Ltd.
HeatGEN Technical Services

📍 HO : Jai Ganesh Vision, "A Wing", Office No. 328/A Akurdi, Pune-411035
Factory : E-28/2, BG Block, Philips Chowk, MIDC Bhosari, Pune-411026

📞 020-46742525

For Technical : +91 9890167371 / 9527112277

For Sales : +91 9527112299 / 9527112288

🌐 www.heatgen.in ✉ sales@heatgen.in | info@heatgen.in